

The Fontaine

1827



3 Bedrooms - 2 Baths

Standard Front Porch & Garage

Optional Brick or Stone Front/Foundation



The Fontaine

1827 SF

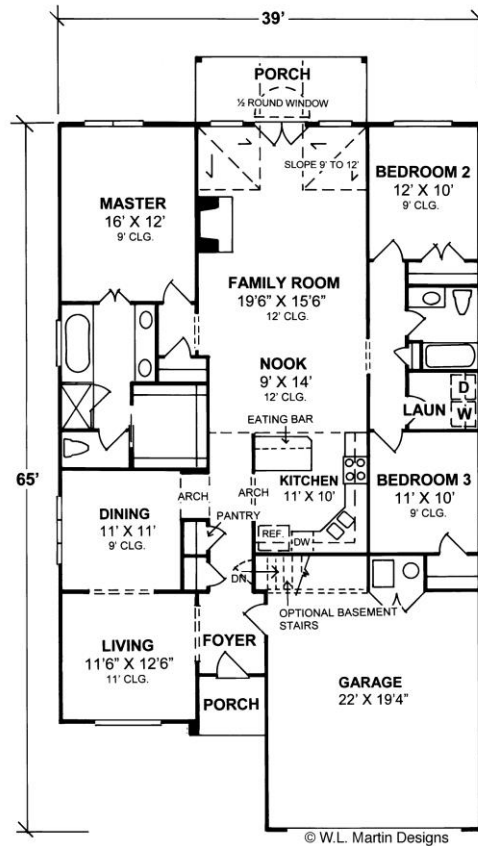

First Floor Plan

Standard Front Porch & Garage

(Rear Porch and Elevated Ceilings are optional)

www.bethelbuilders-va.com

540-748-8810

info@bethelbuilders-va.com



These floor plans and renderings are for illustrative purposes only and may vary from actual plans. Room sizes and square footages are approximate. This information is deemed reliable, but is not guaranteed and is subject to change without notice. Web site, renderings and photos may contain optional features for exhibition purposes only and not included in the purchase price unless otherwise expressly provided for. Minor floor plan changes and dimension changes per local code. Plans Copyrighted 2015 by Bethel Builders, LLC